

Pelton & Crane

SOLARIS

Use & Care

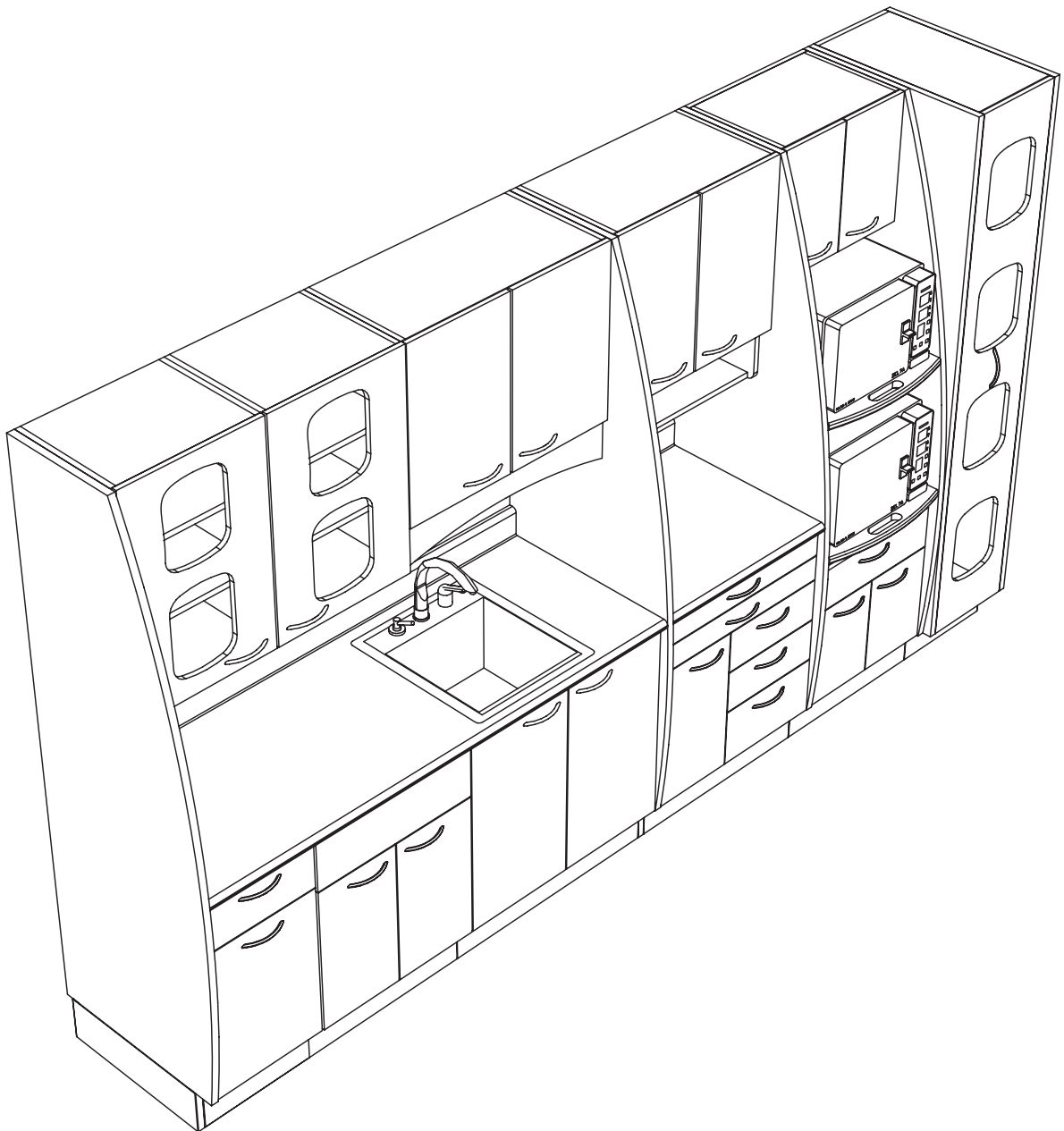

TO OUR CUSTOMER

Thank you for purchasing your new Solaris Sterilization Center. It is engineered to provide many years of reliable performance. However, a certain amount of care is required. Conscientious adherence to the **Maintenance Instructions** will ensure that your unit will function to your satisfaction for many years to come.

Therefore, we have provided you with a set of technical literature, which should be kept for quick and easy reference.

Please refer to the Operating Instructions enclosed with respective hand pieces. In order to protect your rights under the warranty, the purchaser must register the unit by filling in the warranty information provided.

TABLE OF CONTENT

Regulatory Information	3
Product Identification	4
Familiarization	
Stage 1- Receiving/Cleaning/Decontamination	5
Stage 2- Preparation and Packaging	6
Stage 3- Sterilization	6
Stage 4- Sterile Storage	7
Operation	
Electrical Supply (All Staging Areas)	8
Cabinet Functions for Stages 1 and 2	9
Cabinet Functions for Stage 1	10
Cabinet Functions for Stage 2	11
Cabinet Functions for Stage 3	12
Cabinet Functions for Stage 4	12
Maintenance	
Cleaning and Disinfecting	13
Cleaning Cabinet Surface	14
Cleaning Solid Surface Countertop	15
Cleaning Stainless Steel	16
Cleaning HVE	17
Disinfecting and Sterilization	18
Adjustment	
Cabinet Adjustment	19

Technical Support

Technical assistance is available Monday through Friday, 8:00 am to 6:00 P.M. (Eastern Standard Time).

Phone: 800-659-5922
Fax: 704-583-8506

REGULATORY INFORMATION

Safety Notes: This unit is not used in rooms where an explosion hazard exists.

The pre-installation of the facility must be performed in accordance with the requirements outlined in our "Pre-installation" Instructions.

As the manufacturer of dental equipment, we can only assume responsibility from the safety related performance of the unit, if maintenance and repair are carried out by the manufacturer, or by agencies authorized by Pelton & Crane for this purpose, and if needed components affecting the safety of the appliance are replaced exclusively by original spare-parts.

We suggest that you request a certificate stating the type and extent of the work performed, from those performing such work, if necessary stating any alterations of the rated parameters or operating ranges, as well as date, name of organization and signature.

This type of appliance is in conformity with the requirements of UL 962 2nd Ed. CSA C22.2 No. 203.1-94. Due to legal regulations, alterations of the treatment unit, which could impair the safety of the operator, patient, or third parties, are not lawful! For reasons of product safety, only original Pelton & Crane accessories approved for this product, or accessories by third parties, which have been approved by Pelton & Crane, may be used. Using non-approved accessories is at the risk of the user. **In order to prevent injury to persons and damage to the equipment, you must also read the warning and safety notes given in this User's Manual. These are emphasized with WARNING, CAUTION and NOTE.**

Product Disposal

Contact your local authorized dealer for proper disposal of the device to ensure compliance with your local environmental regulations.

Obtaining Technical Literature

The manufacturer will make available on request circuit diagrams, component parts lists, descriptions, calibration instructions or other information that will assist technical personnel to repair and replace serviceable items.

Technical Description

Model Designation: Solaris (SSC-142)
Power Supply: 115V~ 50-60Hz, 15A Service
240V~ 50-60Hz, 3.5A Service

Protection against harmful ingress penetration of water: ordinary equipment

Symbol Identification

 OFF/ON Power Switch

 Alternating Current

 Ground



CAUTION: Failure to carefully follow the described procedure may result in damage to the equipment.



WARNING: Failure to carefully follow the described procedure may result in damage to the equipment and the operator.



Risk of electrical shock present. Make sure power is disconnected before attempting this procedure.

IMPORTANT SAFETY INSTRUCTIONS



SAVE THESE INSTRUCTIONS!

Caution: When performing maintenance, service or if system is being moved. Disconnect all circuits to this equipment.



Warning To avoid electrical shock and personal injury or damage to the cabinet, do not remove covers from the electrical strips and utility box. Only authorized service technicians should attempt to service this equipment. Use of other than authorized technicians will void the warranty.

Warning: Risk of electrical shock: This product shall be grounded in accordance with applicable local codes and national electrical codes.



Warning: To reduce the risk of burns, fire, electric shock, or injuries:

- Disconnect all circuits before putting on or taking off parts.
- Close supervision is necessary when this unit is used by or near children, invalids, or disabled persons.
- Use this unit only for its intended use as described in the Use & Care Manual. Do not use attachments not recommended by the manufacturer.
- Never operate this equipment if it is not working properly. Contact an authorized service technician for repairs.
- Never drop or insert any object into any opening.
- Do not use outdoors.
- Do not operate where aerosol (spray) products are being used or where oxygen is being administered.
- When loading always put heavier items at the bottom and not near the top in order to help prevent the possibility of the equipment tipping over.



Warning: Do not use this equipment to support video equipment such as television or computer monitors.

PRODUCT IDENTIFICATION

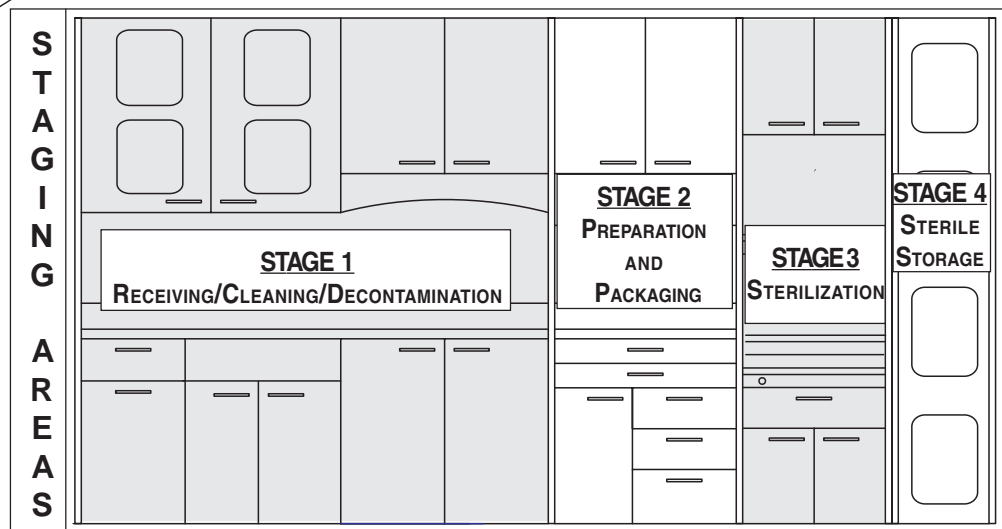
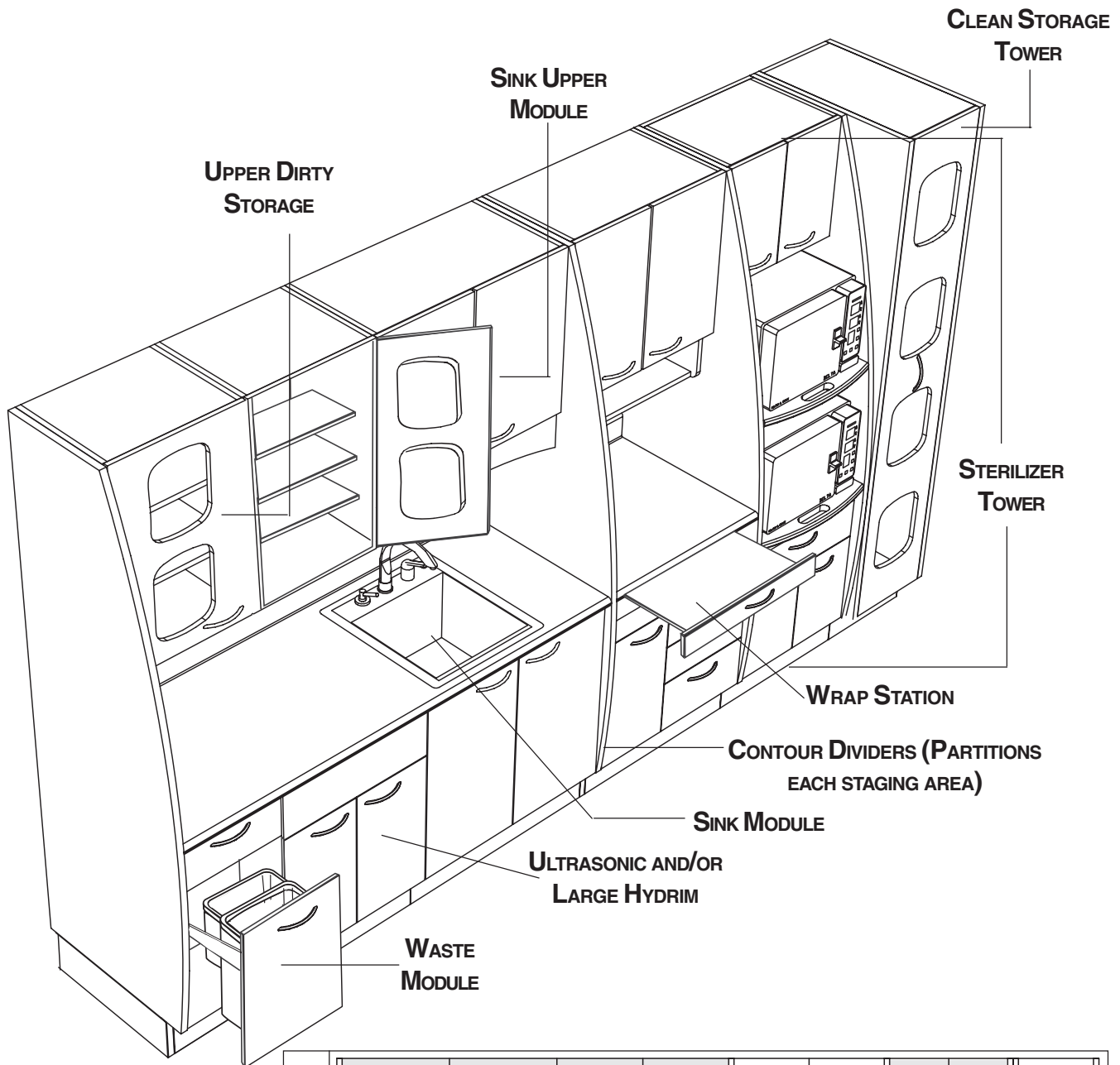

FAMILIARIZATION

The Solaris Sterilization Center is uniquely designed into four staging sections that allows the user to keep each process of sterilization separated. Each stage station is divided by a partition to reduce cross contamination and to improve manageable flow between each station. Refer to the "Staging Area Chart" located on the previous page to identify the areas discussed in these instructions.

Stage 1- Receiving/Cleaning/Decontamination

1. The 30" tall upper instrument staging area is equipped with three shelves to store contaminated instruments. The optional pneumatic foot pedal located at the base of the optional waste module, opens the upper storage doors.
2. The base cabinet houses a large container for paper waste and a red smaller one for biohazard waste material.
3. Extra storage is located in the base to store frequently used supplies. Ultrasonic station may be recessed in the base cabinet (ultrasonic not included). False panel can be utilized for accessories.
4. The 14" x 18" x 10" stainless steel sink accommodates large bulk cassettes that can be difficult to clean. An HVE canister and an integrated drain board are equipped in the sink module to assist in cleanup.
5. The sink module also houses the utilities allowing easy access when maintenance is required.

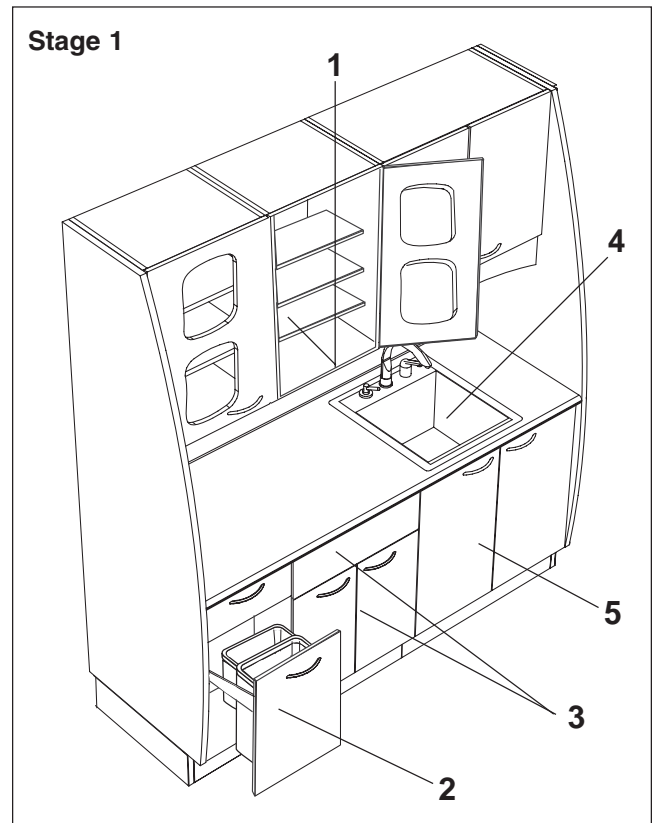

6. The upper sink cabinet (**A**) houses the towel (**B**) and double glove dispensers (**C**) conveniently located in fingertip reach.

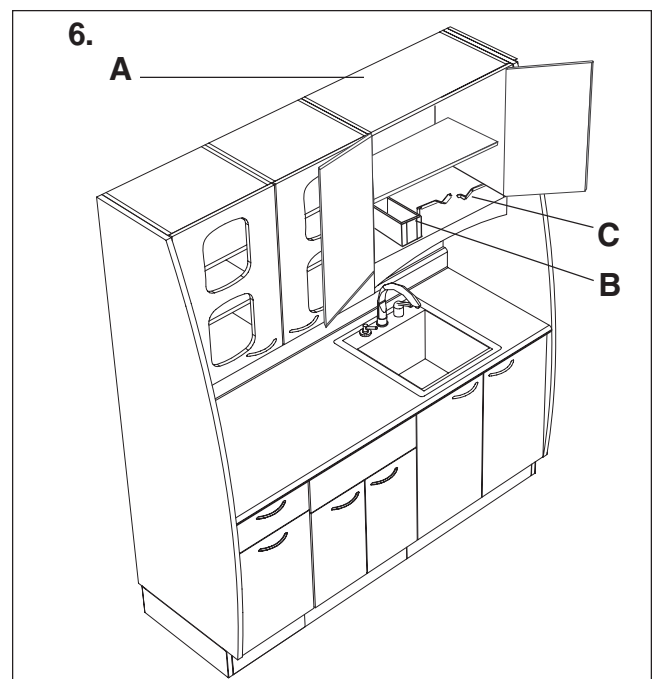

Stage 2- Preparation and Packaging Area

1. The two top drawers pull out to a work space for wrapping up to 24" x 24" wraps. This area accommodates large and small wrap cassettes and packages efficiently.
2. The drawers underneath contains inserts that accommodates pouches and bags for individual instrumentation.
3. The drop down allows for easy access to supplies such as tape and indicators strips. An electrical outlet is incorporated into this module for optional equipment that requires electrical resource.
4. An upper storage and Lower storage modules provide extra space for storing essentials that are needed when preparing and packaging instruments.

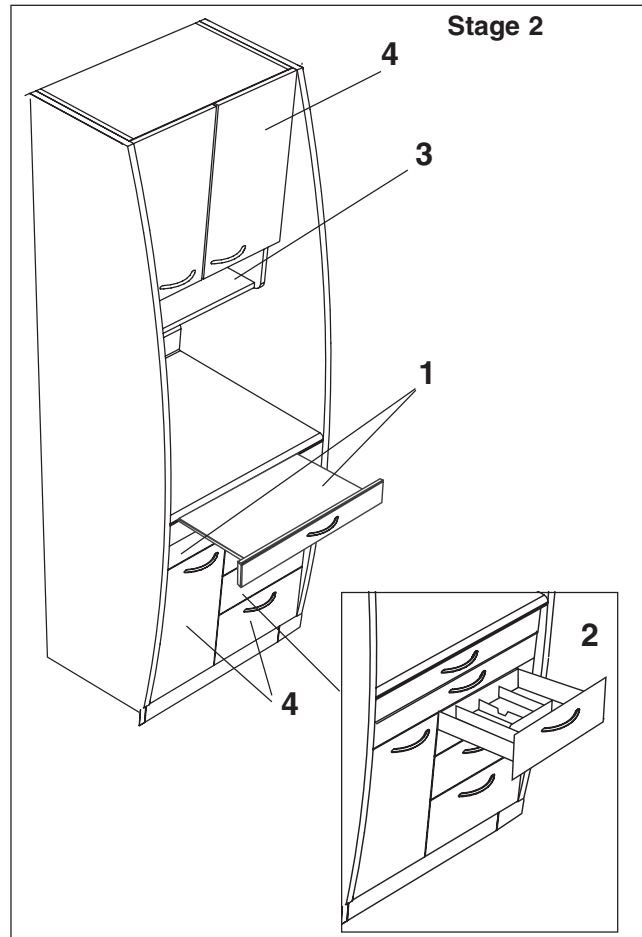

Stage 3- Sterilization Area

1. The two 1" solid surface shelves with drip proof troughs fully extends out and are lower for all user access. These shelves resist heat and moisture when sterilizing instruments.
2. A vacuum-assisted reservoir drain located above the drawer, allows the user to drain the sterilizer directly into the reservoir drain eliminating the use of a bucket.
3. The storage area in the base of the cabinet provides an area to store distill water or a steam collector.
4. An upper storage module provide extra space for storing essentials that are needed when preparing for sterilization.

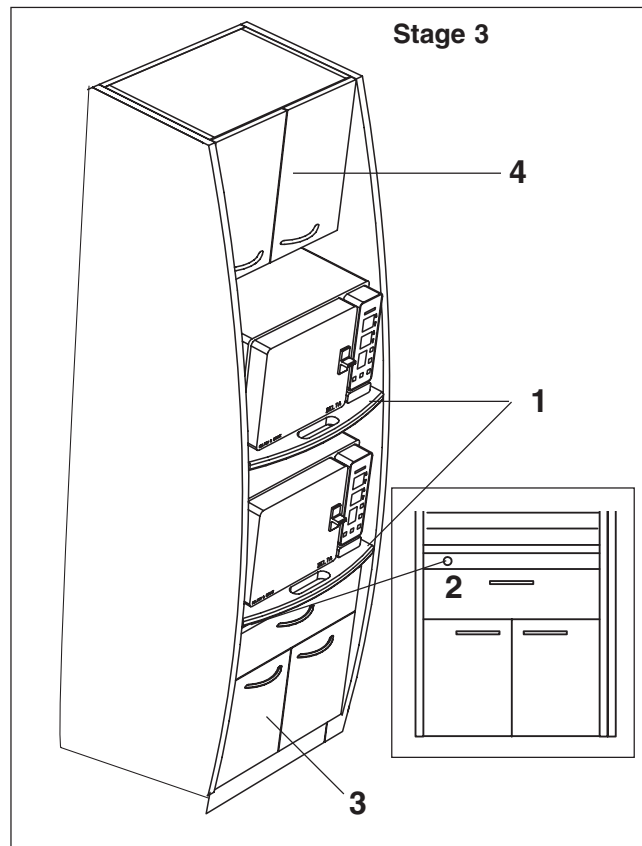

Stage 4- Sterile Storage

1. The four viewing panels allow easy inspection of contents.
2. Interior lighting for easy identification of sterile cassettes.
3. Five racks to accommodate all varieties and sizes of cassettes.



Warning: Use caution when pulling the sterile storage tower out. Pulling the sterile storage tower out too fast could result in the tower coming off the tracks and allow the tower to fall.

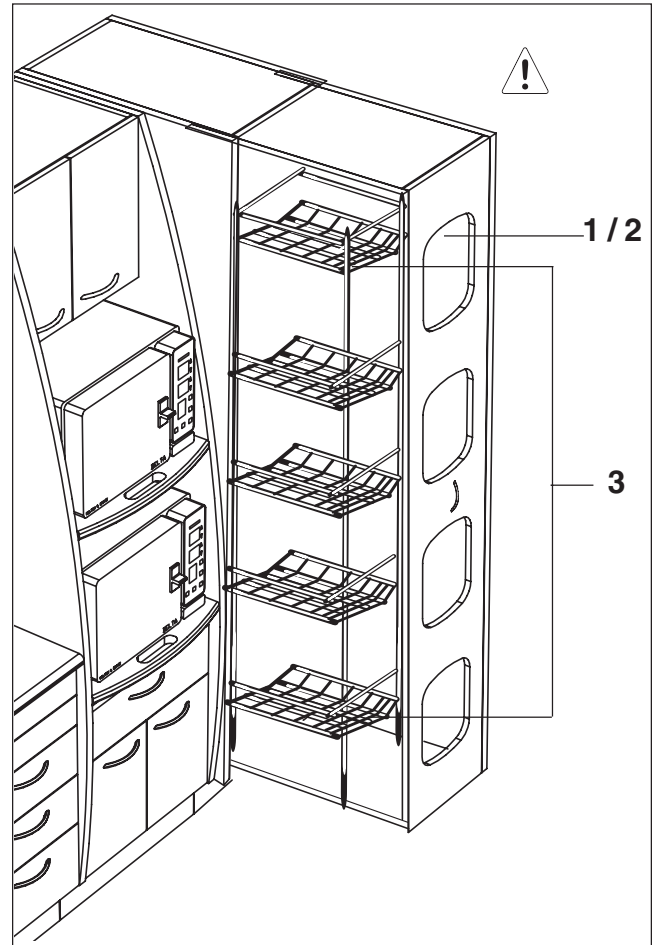

Cabinetry Function

Important: The dental sterilization center system is designed for use in a dental environment and must be operated under the supervision of a trained, licensed professional.

Electrical Supply (All Staging Areas)

Electrical power for the cabinet is supplied by the 120V or 240V main power source in the Sterilization area (Stage 3). The Solaris is equipped with a constant power switch (**A**) located on the control panel above the sink cabinet. Press switch on to have constant power to the cabinetry lights. The lights will remain on until the power switch is pressed to switch lights off.

1. **Electrical Power Strips** are located in the back panels of Stage 1 and Stage 2. The two outlet strips are 120V and runs constant power to the outlet.
2. **Electrical Outlet** is located in Stage 3. This outlet can be hard wire to accommodate a 120V or 240V outlet.
3. The thirteen 13" -**fluorescent task lights (Bulb- Simlite, STB10- max. 10 watts)** located in Stage 1, 2 and Stage 3, 4 are automatically activated when the control panel's power switch is **ON**. The lights will remain on until the control panel power is deactivated. For lamp replacement, see "Task Light Lamp Replacement" section.

NOTE: This cabinet light has a polarized plug (one blade wider than the other) as a feature to reduce the risk of electrical shock. This plug will fit polarized outlet one way only. If the plug does not fit fully in the outlet, reverse the plug. If it still does not fit, contact a qualified electrician. Never use with an extension cord unless plug can be fully inserted. Do not alter the plug.

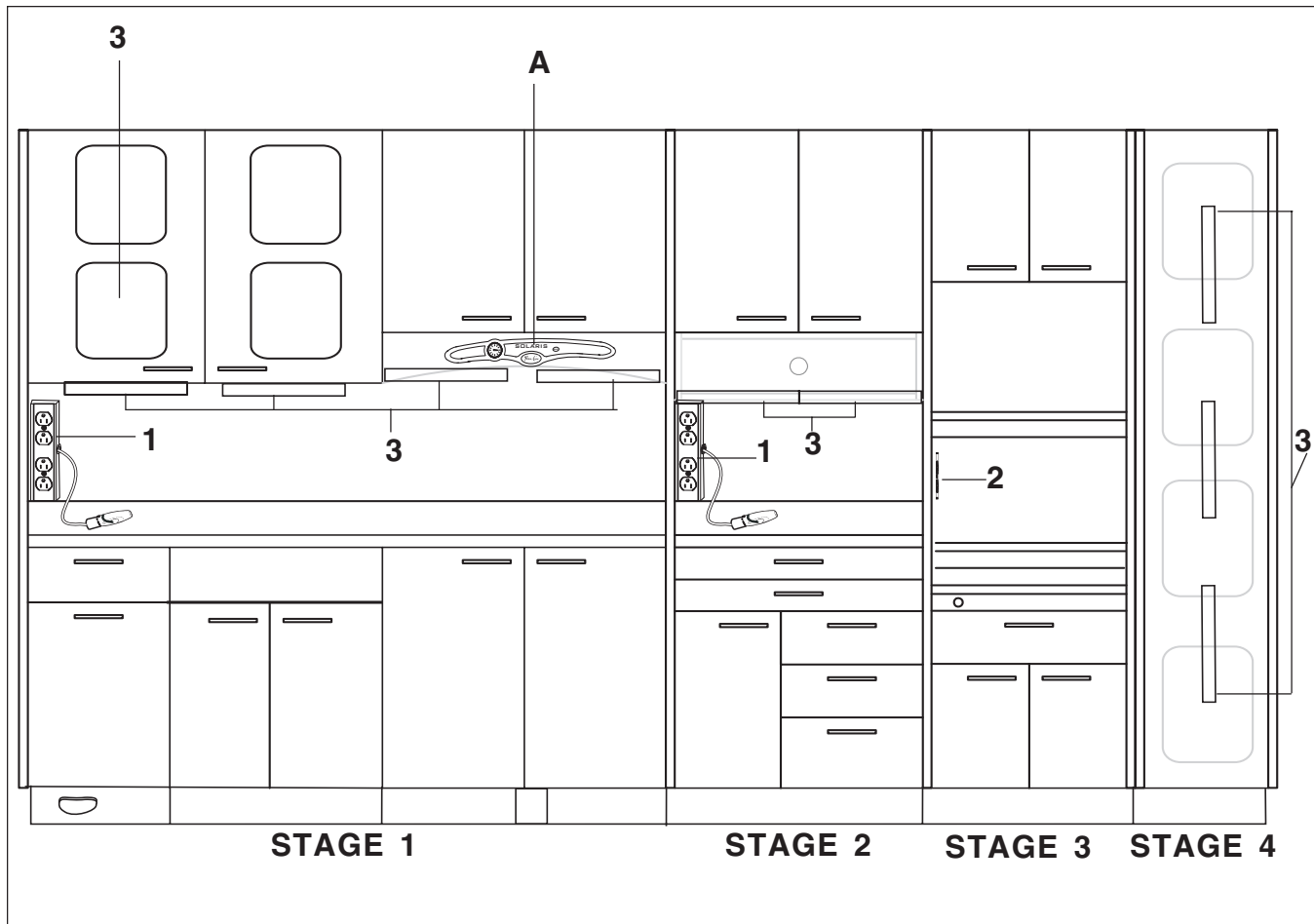

Cabinetry Function for Stages 1 and 2

4. **Air Outlets** are located in the sides of the power strips in Stages 1 and 2. These outlets accept a 3/8" Q.D. fitting and has an integral shut-off valves. 80 PSI is the maximum air pressure. Do not exceed the maximum pressure. Plug the HVE's quick connect into the outlets.
5. **HVE** accepts disposable and non-disposable tips. The outside diameter is 7/16" (1.1 cm) and vacuum is constantly supplied. When operating the HVE, flip lever down at the lowermost position for maximum vacuum flow. Flipping the lever up, vacuum flow decreases.
6. **Optional Pneumatic Doors** in Stage 1 can be opened when the foot pedal at the base of the cabinet is pressed in. When releasing the pedal, the doors will close automatically.

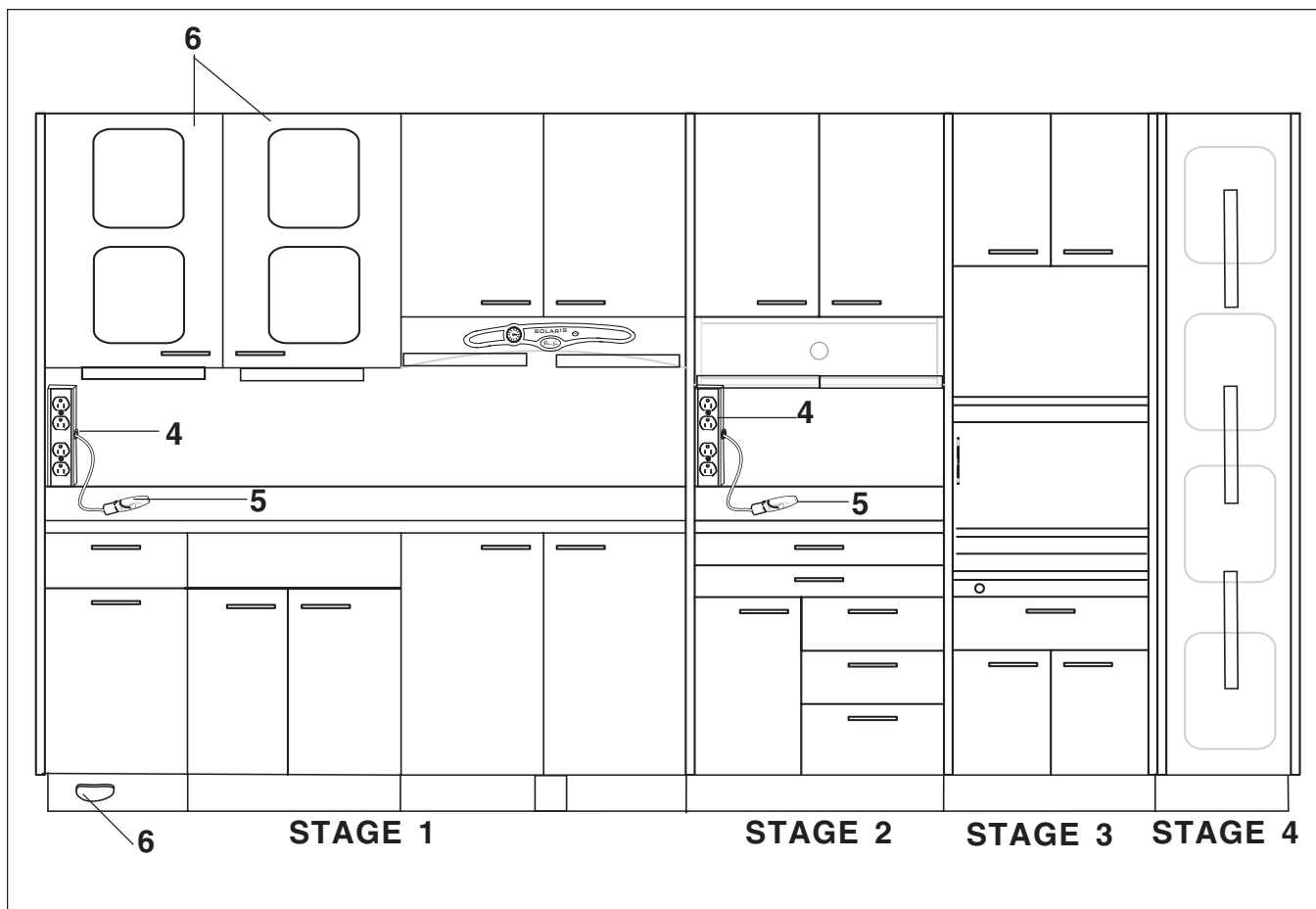
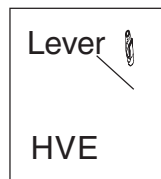

Cabinetry Function for Stage 1

7. The **double glove dispenser** can accommodate two standard glove boxes. Simply slide the boxes face down under the clamps and over the openings.
 8. Insert a tissue box face down or single sheets of paper towels into the **tissue/towel dispenser** and over the opening. Pull the items from the slotted area located underneath the modules.
- An optional cold soak is available for this area. Instruments can be soaked in enzymatic solution before going to Stage 2, Preparation and Wrapping.

STAGE 1

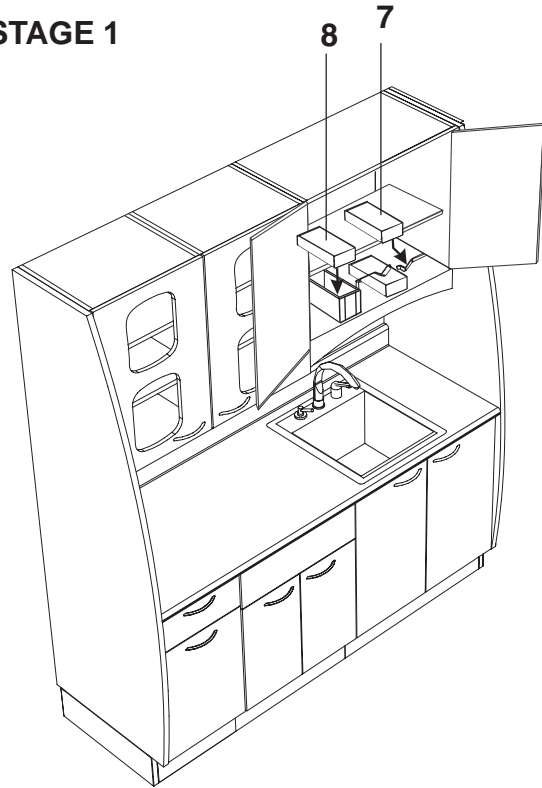

9. **Soap Dispenser:** Remove dispenser top from the sink. Using the funnel provided, fill container and reinstall top. Press the dispenser top until soap is visible.
10. **Faucet:** The faucet water flow can be activated by the optional Tapmaster foot control located in the sink metal subbase. To activate water flow, press kick pedal by foot and release pedal to stop water flow.
11. The **water flow** is controlled by the faucet's handle. Turning handle right activates the cold water and turning it left activates the hot water. Pulling handle back increases water pressure. Pulling handle forward decreases pressure.

An optional lotion dispenser are available for this area. When refilling the dispenser, rinse the container out thoroughly to prevent the it from becoming clogged and prevents bacteria from growing inside the container.

STAGE 1

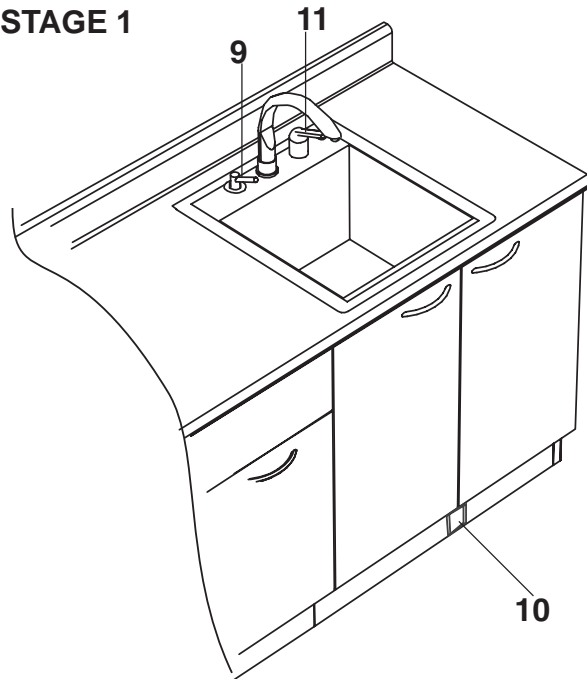

Cabinetry Function for Stage 2

9. **Wrapping Station:** Preparation and packaging in Stage 2 allows the user to wrap and package up to 24" x 24" wraps and room for packaging large and small cassettes.
10. The **open module** can be utilized to store supplies that are used in this area such as tape dispensers, indicator strips and a heat and seal.
11. The **upper storage and lower storage** can accommodate cassettes and packaging materials right at fingertip reach.
12. The **drawers** contain inserts that pouches and bags for instruments can be stored.
13. Stage 2 is equipped with a electrical strip and air hook up as previously stated in steps 2,4 and 5.

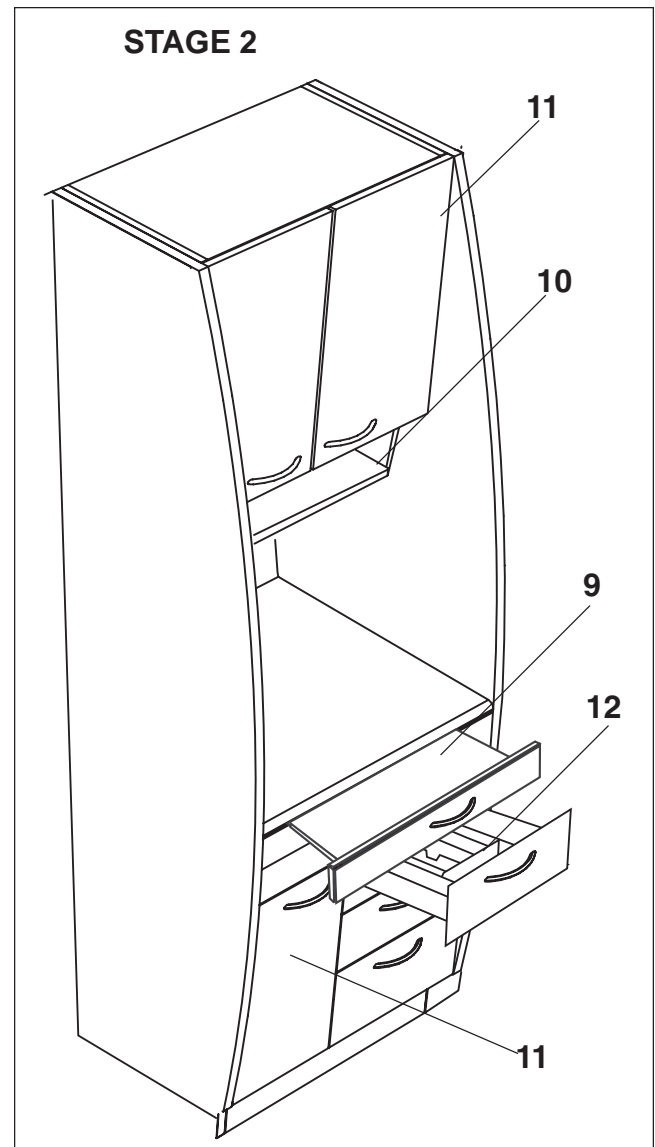

Cabinetry Function for Stage 3



DANGER: Maximum load for the sterilizer shelf is 90 lbs. Do not exceed the maximum load. Doing so can cause bodily harm and damage to the unit.

14. The two **pull out shelves** are equipped with drip troughs that resist heat and moisture. The tower will accommodate two autoclaves or shelves for statim sterilizer.
15. Upper storage and lower storage areas accommodates the essentials that are needed for sterilization.
16. A vacuum-assisted reservoir drain is equipped in the tower below the bottom shelf.

Using the quick connect drain tube (not supplied with cabinet) locate the quick drain connection on the autoclave (illustration depicts the Delta XL Sterilizer) Connect the connector into the tower. Press the drain tube connector into the connection on the autoclave. Follow the autoclave manufacturer's Use & Care Manual for draining the reservoir. The residue will be vacuumed into the vacuum canister located under the sink.

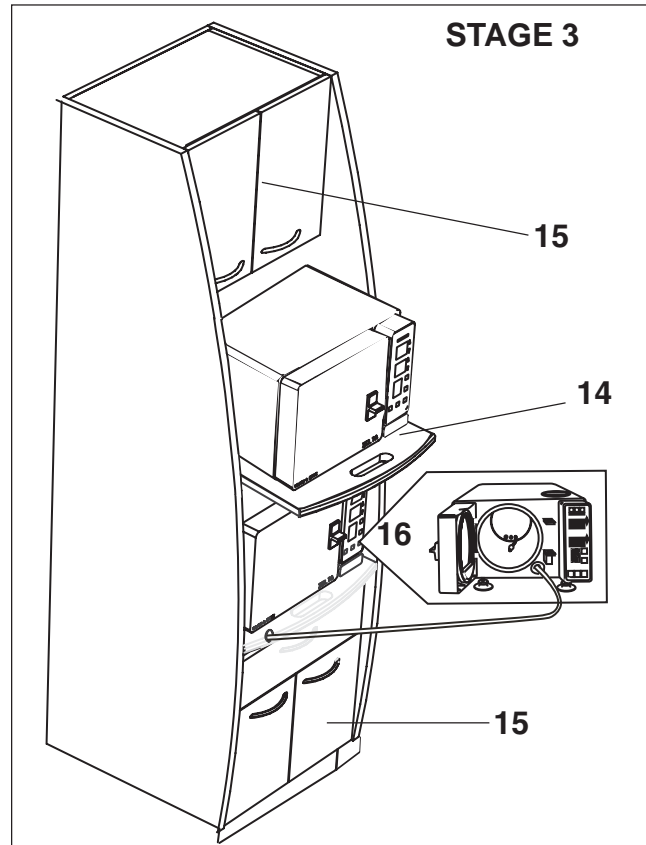

Cabinetry Function for Stage 4

14. Stage 4 is a clean storage tower that is equipped with five adjustable racks. The tower swivels to a 180° for easy access to clean and sterilized essentials.



Warning: Use caution when pulling the sterile storage tower out. Pulling the sterile storage tower out too fast could result in the tower coming off the tracks and allow the tower to fall.

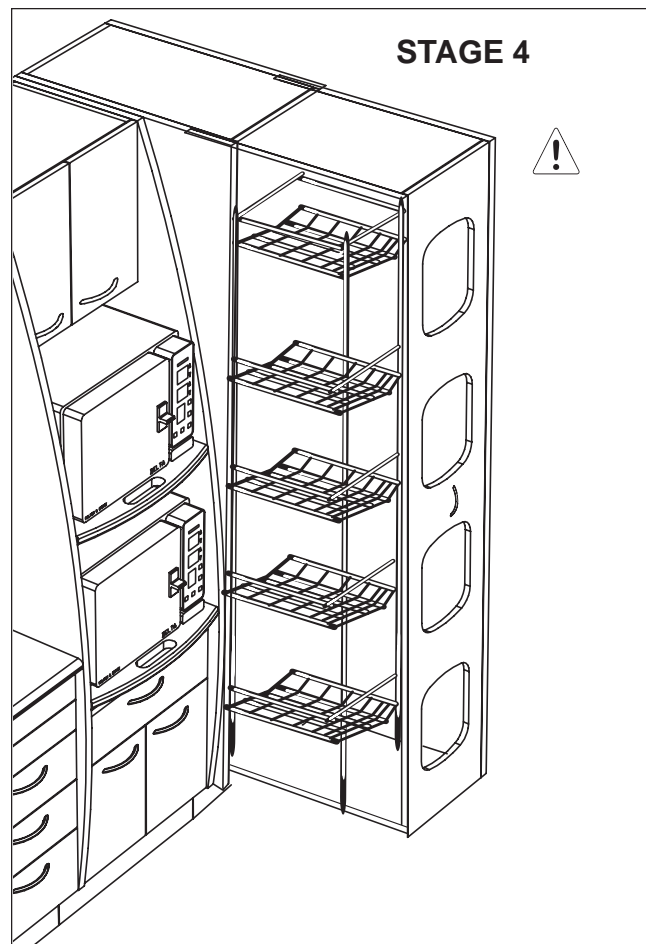

Cleaning and Disinfecting Equipment

Infection control in the dental office continues to be a high priority for our customers and end users. OSHA, the ADA and the CDC are also involved in this complex issue.

Pelton & Crane will not attempt to specify the required intervals for disinfection nor can it recommend the overall best surface disinfectant. Please refer to the Infection Control Recommendations published by the American Dental Association for further information. The question is often asked, "What should I use to disinfect my dental unit?" This question is more complex than it seems because of the wide variety of products on the market as well as formulations of the products changing to meet the needs of increased asepsis.

Barrier Technique

Pelton & Crane strongly advocates the barrier technique be used whenever possible to preserve the finish and appearance of the equipment.

Wherever possible disposable barriers should be used and changed between patients. The barrier technique will ensure maximum long term durability of the surfaces and finishes of the equipment.

Chemical Disinfection

Regardless of the chemical disinfectant used, it is imperative that the equipment be thoroughly washed with mild soap and warm water at least once per day. This wash down will minimize the harmful effects of chemical disinfectant residues being allowed to accumulate on the equipment.

When using chemical disinfectants, always pay strict attention to the manufacturer's disinfectant directions. When using concentrated disinfectants, measure the concentrate carefully and mix according to package directions. Disinfectant solutions that are relatively harmless to surfaces at their recommended strengths can be corrosive at higher than recommended dilution ratios.

Unacceptable Disinfectants

These disinfectants **will harm** the surface finishes of the equipment and are not recommended. **Use of these products will void your warranty.**

<u>Chemical Composition</u>	<u>Trade Names</u>
Strong Phenols/ Phenols-Alcohol Combination	Lysol, Lysol 2, Lysol Professional, Coe Foam, CoeSpray Pump, Vitaphene, Omni II
Sodium Hypochlorite Household Bleach	Clorox, Ajax, Purex
Alcohol	
Household Cleaning Products	

Conditionally Acceptable Disinfectants.

These disinfectants have been found to be the **least harmful** to the equipment surfaces by our test methods.

<u>Chemical Composition</u>	<u>Trade Names</u>
Iodophors**	Biocide, Aseptic-IDC, Wescodyne, SD5, Promeddyne, Iodo-Five
Mild Phenols	Procide ES, Asepti-Steryl, Aerosol
Glutaraldehyde/ Phenol Sprays	Sterall Spray, Coldspor
Synergized Super Quat	Dis-cide, Cavicide, Kleenaseptic
Phenol/Water Sprays	Top-Cide, Sporicidin Pump Spray, Birex se

**Pelton & Crane makes no representation as to the disinfectant efficacy of these products. We make no warranty expressed or implied that these disinfectants will not damage the surface finishes. Damage and discoloration of the surface finishes are not covered under the warranty.*

***Iodophor-based disinfectants will cause yellow staining on many surfaces. Regular washing with soap and water will minimize this staining. Iodophor neutralizers such as Promeddyne are also available.*

Syringe Note: To avoid damage to your syringe, it is necessary that only manufacturer's recommended replacement parts are to be used. Use of any other manufacturer's part will damage the syringe and void its warranty.

Cleaning Cabinetry Surfaces

Disinfecting the Surfaces

Disinfect cabinet surfaces by spraying or wiping with surface disinfectant using the spray-wipe-spray technique as endorsed by OSAP (Office Sterilization and Asepsis Procedures).



CAUTION: Follow the manufacturer's directions for use of disinfectants! Use only the disinfectants that have been tested and approved!

For additional infection control as well as to reassure your patients that you are following strong protective practices, we strongly recommend the use of coverings such as plastic, foil or treated paper or autoclavable components (such as light handles, assistant's instrumentation cover, tray mat, etc.) as well as the use of surface cleaners and disinfectants either daily or following each patient, depending on the circumstances.

Cleaning the Surfaces

To remove dirt and disinfectant residues, clean the surfaces regularly with a normal commercial cleaning agent.



CAUTION: DO NOT use abrasive cleaners! Doing so can cause damage to the cabinet surface.

Cleaning Agents

Because of their high concentration and the substances they contain, many cleaning agents can affect surfaces by dissolving, etching, bleaching or discoloring! Carefully wipe surface with a damp cloth and use an appropriate cleaning agent to lessen potential damage!

Cleaning Solid Surface Countertop

General Care

Wipe the surface with a damp cloth. If stain develops, clean with soap and water. Or if preferred, Windex® can be used. Always towel dry to prevent spotting.



CAUTION: Do not use Formula 409® or Fantastik® to clean the solid surfacing. Chemicals in these products could fade the surface.

Removing Stains

When stains do not clean with soap and water, take the following steps.
Using a circular motion, apply an abrasive cleaner and buff with a Scotch-Brite® pad.

IMPORTANT: When buffing, sanding or applying abrasive cleaners, always use a circular motion to preserve original countertop finish.

Cuts and Scratches

Sand the surface lightly in a circular motion with 220 grit sandpaper. Wipe the surface, then follow with an abrasive cleaner. End by buffing with a maroon or green Scotch-Brite® pad.

Hygiene

Pelton & Crane Solid Surfacing is nonporous and provides an inhospitable environment for germ or mildew growth. With proper care and cleaning, the countertop will remain very sanitary.

General Precautions

- Do not set hot items directly onto the countertop. Excessive heat can mar the countertop.
- Do not use sharp objects directly on the countertop. Although minor scratches and cuts can be repaired, care should be taken to keep the surface looking new.
- Do not expose surface to harsh chemicals such as paint remover, turpentine, nail polish remover containing acetone, or stove or drain cleaners. If these chemicals comes in contact with the surface, immediately wash surface off with water using appropriate precautions. Buff in a circular motion with Scotch-Brite® pad.

Cleaning Stainless Steel Fixtures

General Care

Clean surface using warm water with a mild non-scratching abrasive powders such as typical household cleaner. Wipe with a sponge or a clean cloth. **Do not use steel brushes or steel wool as they may cause scratches and will leave particles embedded on the surface which can lead to RUSTING.**

For more aggressive cleaning, a small amount of vinegar can be added to the cleaner. Rinse the surface with warm water. Once thoroughly rinsed, wipe the surface completely with a dry towel to avoid water spots.

Stains

Stains resulting from normal use are the most common surface contaminates. Using a glass cleaner, spray and gently wipe the surface with a soft cloth. Thoroughly rinse with warm water. Wipe surface completely with a dry towel to avoid water spots.

Tough stains may require a combination of detergent plus a solvent such as non-halogenated products that does not contain chlorine, iodine, bromine or astatine. Pour solvent onto the stain, rub in the direction of the grain. Rinse the surface with warm water. Once thoroughly rinsed, wipe the surface completely with a dry towel to avoid water spots.

Scratch Repair

Repair surface scratches using the following technique. Using 120 grit emery cloth or paper, sand in the direction of the grain using firm pressure. Once scratch is removed, polish surface using a 3M scotch brite pads. Polish in the direction of the grain until the original finish is restored.

Cleaning HVE

Draw clean water through HVE valve, while opening and closing it several times. Leave the valve open for several seconds to allow all of the water to clear the hoses.

We recommend that you draw a vacuum system sanitizing solution through the HVE valve, while opening and closing it.

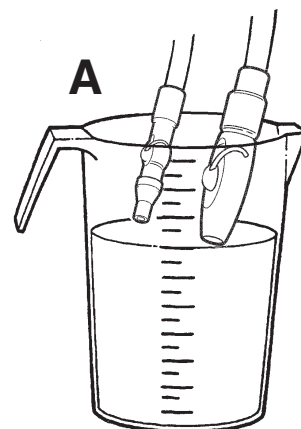

Cleaning

Clean the external surfaces of the vacuum instruments using a solution of mild detergent and warm water.

! CAUTION: Do not use sodium hypochlorite on these instruments doing so will cause permanent damage.

Never use powdered cleansers, scouring pads or abrasive scrubbers, any of which can damage the finishes.

Sterilization

Remove each valve from its tubing for sterilization.

In any situation involving high-risk patients, it is recommended that the instruments be removed for sterilization after every patient.

! CAUTION: Temperature should never exceed 275° F or 135° C. Do not allow the instrument to contact the walls of the sterilizer, and avoid placing it in close proximity to the heating elements.

As Needed

Disassemble the valve and lubricate the internal parts when operation becomes stiff or sticky. Clean the inner surfaces and apply a small amount

Cleaning the Solids Collector

At least once a week, the solids collector screen should be removed for cleaning.

The solids collector is located in the sink base. 1 Turn off the vacuum. Twist off the solids collector cap and lift out the screen. If excessive amount of material is in the screen, more frequent cleaning is necessary.

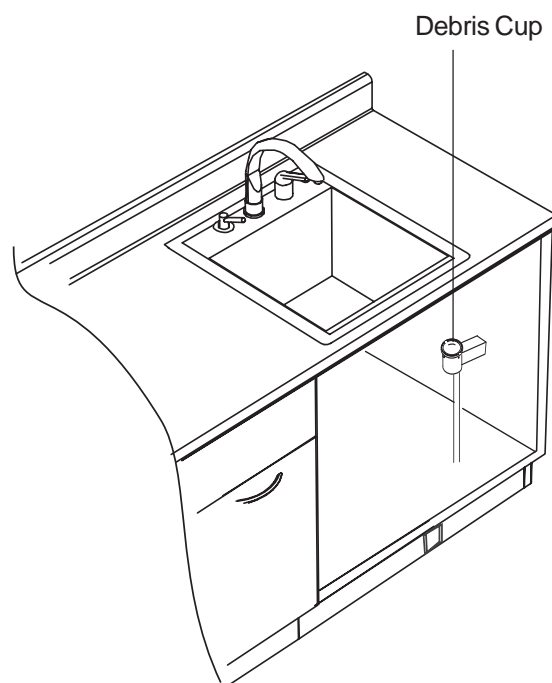

Disinfecting and Sterilization

The procedures given here apply to the HVE vacuum instruments. Additional information on sterilization and disinfection may be obtained from the American Dental Association and the Centers for Disease Control.

Disinfecting

The use of chemical disinfecting agents is not necessary if the instrument is going to be sterilized.

Your dental supply dealer will have current information from all disinfectant manufacturers regarding their product's effectiveness. Always follow the product manufacturer's recommendations for use. The following table lists the disinfectants commonly available through dental supply sources. When used as directed, these products are recommended in the disinfection of your dental unit.

Disinfectant	Brand Name	Manufacturer
Phenol/Water Sprays	BIREX se Sporicidin	Biotrol, Int. Ash Div. Dentsply Int'l
Glutaraldehyde Phenol Sprays	Coldspor Procide Spray Sterall Spray	Matrex Research Cottrell Ltd. Colgate Hoyt
Iododphors	Asepti-IDC Biocide Promedyn Iodo-Five	Huntington Labs Biotrol, Int. Cottrell, Ltd. Amsco Medical Prod.
Iodophor Neutralizers	Promedyn	Cottrell, Ltd.
<i>Table 1: Chemical Disinfectants</i>		

NOTE

While none of the products listed in Table 1 will adversely affect the performance of your instruments, most chemical disinfectants can be expected to cause some degree of discoloration. This can be minimized by frequent cleaning with soap and water, and in the case of Iodophors, regular use of Iodophor Neutralizers.

Sterilization

There are several methods of sterilization that may be used. It is important to remember, however, that regardless of the method you choose, temperatures should never exceed 275° Fahrenheit (135° Celsius).

Any of the following sterilization methods may be safely used on your vacuum instruments:

- Steam Autoclave
- Ethylene Oxide Gas
- Chemical Vapor Process

Do not allow the instruments to come into contact with the walls of the sterilizer. Avoid placing the instruments in close proximity to the sterilizer heating element.

Dry heat sterilization is not recommended because of the difficulty in maintaining the precise temperature control necessary to prevent damage to the instruments.

Do not microwave vacuum instrument as this may cause internal damage to your microwave oven.

Important: When using the chemical vapor process, it is essential to rinse out all cleaning agents with clear water. The internal surfaces and passages must be thoroughly purged of residual cleaning agents by flushing with water then isopropyl alcohol. This will prevent the formation of a crystalline residue resulting from reactions between the chemical vapor solutions and cleaning agents.

Door Hinge Adjustment

The door are adjusted at the factory so that doors open and close properly. However, an occasional adjustment may be required over a period of usage.

Unsnap hinge cover from hinge. Using a Phillips head screw driver, adjust doors as follow:

1. **Side Adjustment-** Turn screw (1) clockwise to move door over to the right and counterclockwise to bring it in to the left. Once adjusted, tighten screw.
2. **Height Adjustment-** Turn screw (2) counterclockwise and lift door up so that it is aligned with the door module. Once adjusted, tighten screw.
3. **Depth Adjustment-** Turn screw (3) clockwise to bring the door in and counterclockwise to bring door out. Once adjusted, tighten screw.

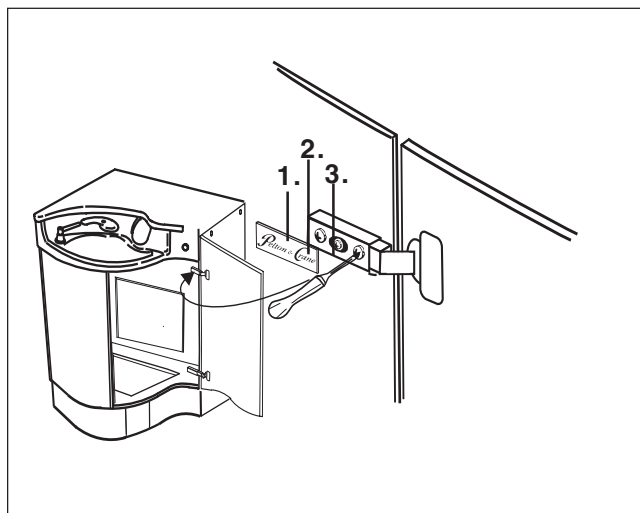

Drawer Adjustment

The drawers are adjusted at the factory. However, an occasional adjustment may be required over a period of usage. These adjusting screws are located in each front corners of the drawer.

Using a Phillips head screwdriver, adjust drawers as follows:

1. **Vertical Adjustment:** Lightly loosen screws (2) counterclockwise, adjust screw (1) up or down, tighten screws (2).
2. **Horizontal Adjustment:** Lightly loosen screws (2), adjust front to desired position, tighten screws (2).
3. **Angle Correction:** Loosen top screw or bottom screw (2) according to your needs. Push angle correction wedge (type 6155) in between, tighten screws (2) and tear off wedge. Angle correction ± 1 .

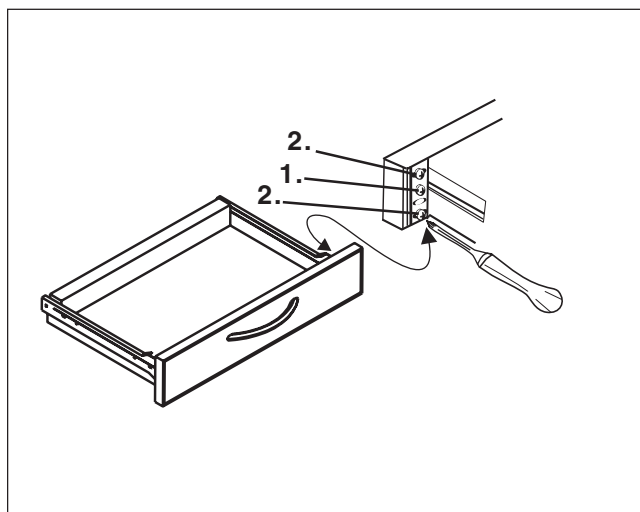

TASK LIGHT LAMP REPLACEMENT

NOTE: This cabinet light has a polarized plug (one blade wider than the other) as a feature to reduce the risk of electrical shock. This plug will fit polarized outlet one way only. If the plug does not fit fully in the outlet, reverse the plug. If it still does not fit, contact a qualified electrician. Never use with an extension cord unless plug can be fully inserted. Do not alter the plug.

NOTE: Use only Slimlite Bulb, SFB 10, 10 Watt. Maximum.

1. To remove lamp, turn tube so the lamp pins are aligned in slots.

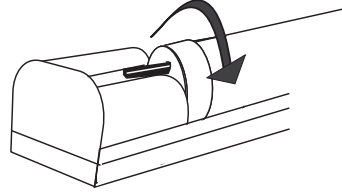

2. Pull out tube.

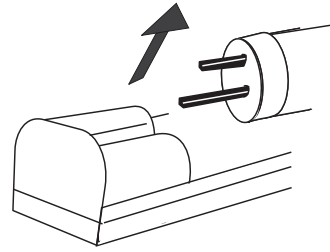

3. To install lamp, Align lamp pins and insert them into lamp holder slots. Turn tube 1/4 turn to secure pin contacts into lamp holder.

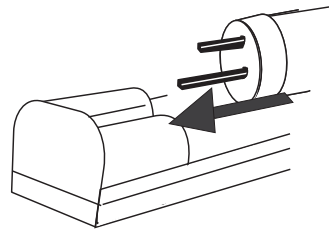

4. Turn lamp 1/4 turn to secure pin contacts into lamp holder.

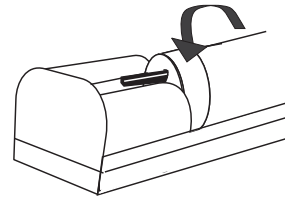

[illegible]

Pelton & Crane
PO Box 7800
Charlotte, NC 28241-7800
USA

©2005, Pelton & Crane
We reserve the right to make any alterations which may be due to any technical improvements.

Order No. **042297**
Rev. 2, 5/05
Printed in USA